

ZOELLNER

ARTS CENTER • LEHIGH UNIVERSITY

420 East Packer Avenue, Bethlehem, PA 18015-3179.

Fowler Black Box Theatre

Technical Information Package



Facility Description: The Zoellner Arts Center, a division of Lehigh University's College of Arts and Sciences, is a 23-year-old arts center housing four resident departments: Lehigh University Art Galleries, the Departments of Music and Theatre, and Administration. All building resources are shared among these four departments. There are three performance spaces: Baker Hall, a 940-seat concert/proscenium stage; Diamond Theatre, a 3/4 thrust stage seating 307; and the Fowler Black Box Theatre, a small multi-configuration space.

Table of Contents - Titles link to indicated section

Contact info.....	Page 3
Seating.....	Page 3
Stage.....	Page 3
Seating.....	Page 3
Stage Floor.....	Page 3
Fly System.....	Page 3
Stretch Wire Grid.....	Page 3
Soft Goods.....	Page 3
Lighting Control.....	Page 3
Lighting Positions.....	Page 3
Lighting Inventory.....	Page 4
Audio.....	Page 4
Intercom & Paging.....	Page 4
Video Projection,,,,,.....	Page 5
Dressing Rooms.....	Page 5
Loading Dock.....	Page 5
Internet Access.....	Page 5
Drawings	
Loading Dock.....	Page 6
Dressing Rooms.....	Page 7
Fowler Black Box Ground Plan.....	Page 8

Address: Shipping and physical address: 420 East Packer Avenue, Bethlehem, PA 18015-3179.

1. Contact Info:

Position	Name	Email	Office Phone
Interim Administrative Director	Phillip Clauser	pjc3@lehigh.edu	610-758-5323
Production Manager	Joshua Kovar	jok7@lehigh.edu	610-758-5894
Assistant Production Manager	R. Elizabeth Miller	rema@lehigh.edu	610-758-5653
Lighting Coordinator	Justin Burns	jeb719@lehigh.edu	610-758-5666
Assistant Lighting Coordinator	Ponder White	jpw319@lehigh.edu	610-758-5644
Audio Coordinator	Phil Ingle	phi214@lehigh.edu	610-758-5871
Stage Coordinator	Becky Eshelman	ree2@lehigh.edu	610-758-5387
Costume Shop Coordinator	Pamela Richey	pdr3@lehigh.edu	610-758-3628
Rentals & Scheduling Manager	Jennifer Mack	jem3@lehigh.edu	610-758-5654
Director of Audience Services	Sandy Anderson	saba@lehigh.edu	610-758-6641
Programming Assistant	Tahya Keenan	pak512@lehigh.edu	610-758-5643
Green Room			610-758-2252
Main Fax #			610-758-6537

2. Stage Floor: Tempered MDF.

3. Stretch Wire Grid:

- a) Reachable via tech booth on the 2nd floor.
- b) Rigging to the grid is not allowed.

4. Soft Goods:

- a) There are 14 black velour curtains on track hung from catwalks on all four sides.
 - i) Each curtain is 18'x12' with 0% fullness.

5. Lighting Control:

- a) ETC ION, located in tech booth (has limited view of stage)
- b) Designer/Tech table with remote video setup is available
- c) House/work light control by ETC Paradigm system (control located both in HL Booth and via iPad or ION)
- d) The black box lighting system is dimmer per circuit and has relay and other modules available.
- e) 96 ETC Sensor 3 dimmers. This includes non-dim and house/work lights

6. Lighting Positions:

The black box has multiple lighting positions:

- a. Tension grid
- b. Gallery pipes (surrounding grid)

7. Lighting Inventory:

The Fowler Black Box and Zoellner Arts Center rely on a shared inventory, and as such, all items are subject to availability. Contact the Lighting Coordinator for the most current inventory.

Manuf.	Unit Type/Model #	Black Box	Shared
Ellipsoidal			
ETC	Source 4 Bodies	88	
ETC	Source 4 19°	13	
ETC	Source 4 26°	25	
ETC	Source 4 36°	32	
ETC	Source 4 50°	18	
Wash			
ETC	Source 4 PAR	12	
Altman	6" Fresnel - 65Q	13	
Automated			
Martin	MAC 2000 Profile	0	4
Martin	MAC 2000 WASH	0	2
Chauvet	Chauvet COLOrado 1-Quad Zoom	0	12
Chauvet	LED Shadow Black Light	0	4
Chauvet	Colorail IRC	0	9
Chauvet	Chauvet Rouge 1 Wash	0	12

8. Audio:

- Mixing Console: Yamaha LS9
- Playback: Qlab 4 on an MacMini and mp3/phone connection
- Speakers: 4 x EAW JF80
- Amplifiers: 8 Crown CTs 1200
- Self powered
- 4 QSC K-10s,
- 2 QSC KS118? Subs
- 4 Galaxy Audio micro-spots MSPA5
- Microphones:
- 2 Shure Wireless handhelds
- 12 channels of ULX-D handhelds or belt packs are available.
- Various Shure, AKG, and DPA mics are available
- Microphone and Speaker patch points are located throughout theater.

9. Intercom/paging:

- Clear Com 2 channel party line system with remote SM station.
- In-house FOH & backstage paging available
- Patch points located throughout theater
- Single channel and dual channel belt packs available.
- Single and double muff headsets available.

10. Video Projection: Diamond Theater and Zoellner Arts Center rely on a shared inventory.

- a. 3 Epson Pro L1505UNL 12,000 lumen laser, Resolution: WUXGA 1920x1200
 - i. Various lens options available
- b. 1 Panasonic PT-EZ570U ,5000 lumen, resolution: WUXGA 1920x1200
 - i. Various lens options available
- c. 1 Epson PowerLite Pro G7000W, 6500 lumen, resolution: WXGA 1280x800
 - i. Various lens options available
- d. 2 Optoma TX783, 5000 Lumen, resolution: XGA 1024x768
 - i. Lens: 1.2x zoom
- e. 1 9'x14' fast fold front/rear projection screen with dress kit
- f. 1 8' tripod screen

11. Dressing Rooms: Located on lower level, one floor below Diamond Theater.

- a) Dressing rooms are a shared resource and might not all be available.
- b) There are 2 individual dressing rooms with private shower/ washroom.
- c) There are 2 4-person dressing rooms with private shower/ & a shared washroom.
- d) There are 2 ensemble dressing rooms. The women's seats 26 and the men's 19. Each has showers and shared washrooms.
- e) Hospitality is usually located inside the greenroom or directly outside.
- f) Laundry room has a single washing machine & an electric dryer.
- g) An iron and a Jiffy steamer are available upon request.
- h) A wig dryer is available upon request.
- i) Rolling wardrobe racks are available.

12. Loading Facilities:

- a) The loading dock is located at 420 East Packer Ave. It is immediately to the right of the parking lot entrance. Please see page 5 for drawing.
- b) Dock will accommodate a 53' trailer and tractor.
 - a. Driveway opening is 14' high.
 - b. The dock is 3' above driveway & has an integral, adjustable dock plate.

13. Internet Access:

- a) There is Wi-Fi available throughout the building, SSID: lehigh-guest. No password needed.
- b) A LAN jack is available in the greenroom. No password needed.
- c) There is a phone located in the greenroom for guest use.
 - a. Long distance calls must be made using calling cards.

Loading Dock Detail

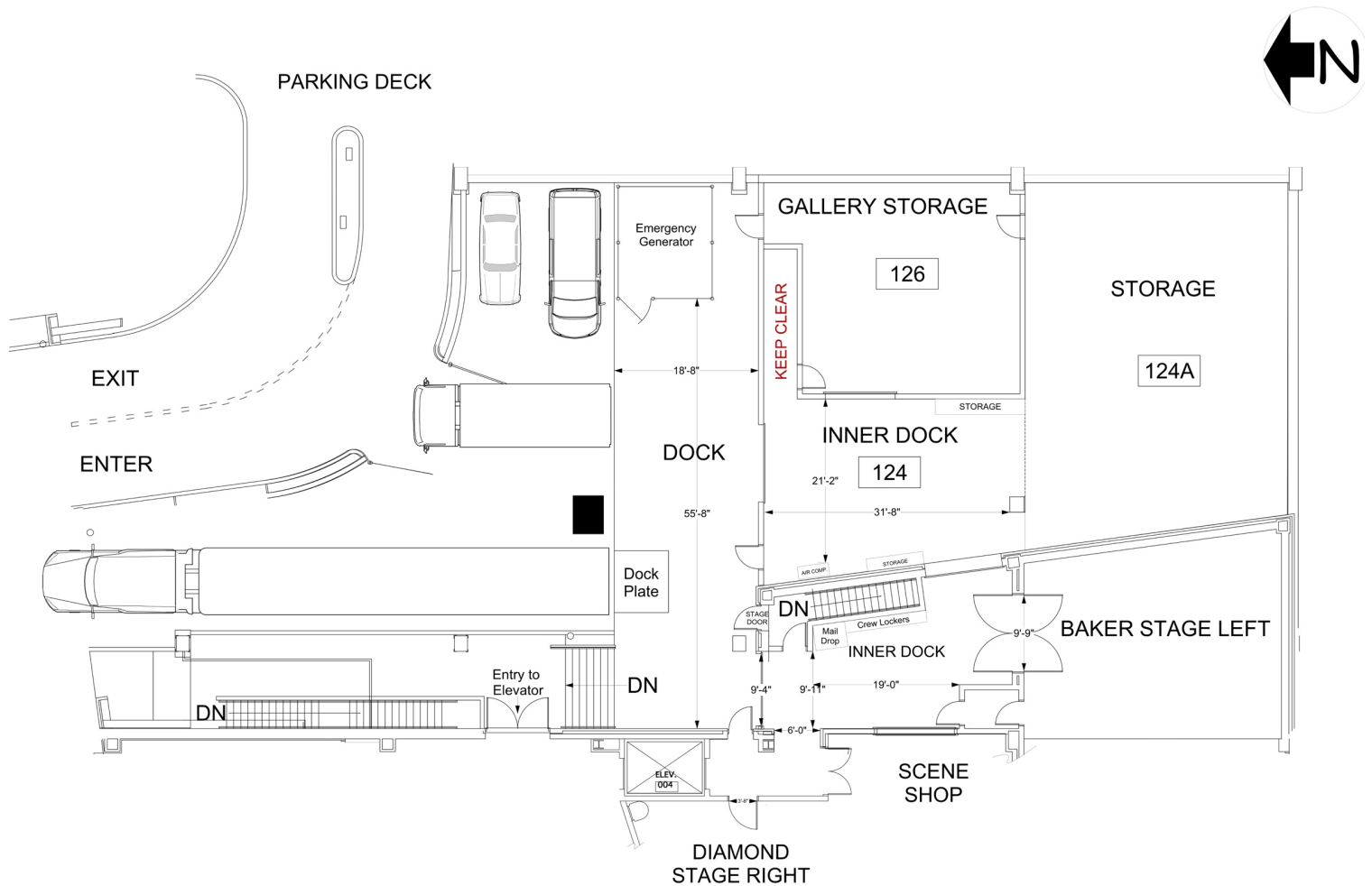

Dressing Room Layout

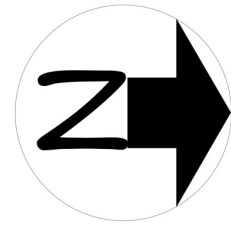

Areas Outlined In Red Are Off Limits

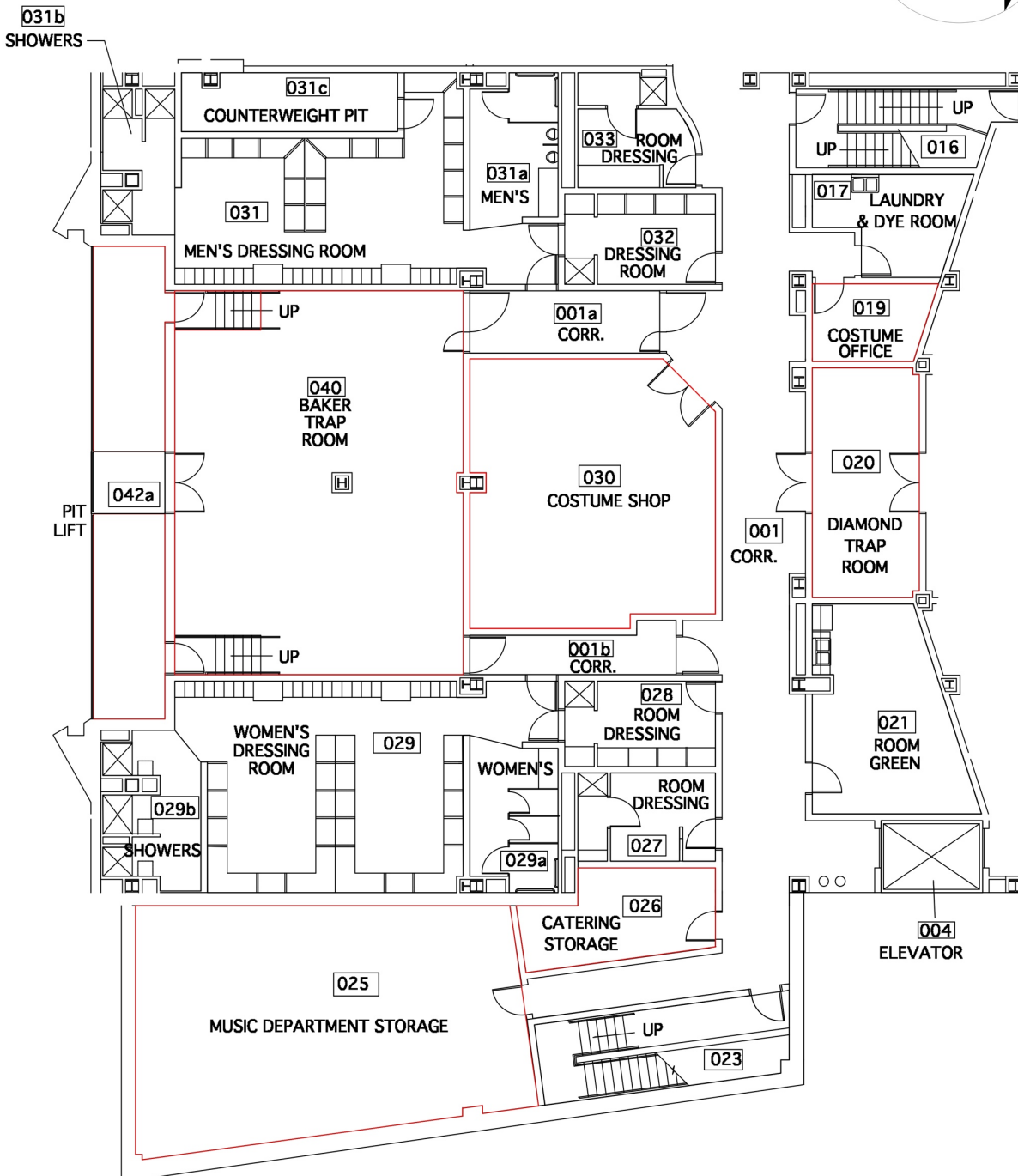

Fowler Black Box

